

THE SILVER DRAGON INN

ABOUT

The Silver Dragon Inn is an inn with a dragon's lair beneath it. The inn is on the edge of a waterfall and has stairs leading down into the underground lair. The lair's other exit is a wide cave mouth behind one of the waterfalls.

Locals are aware that the inn is named for a silver dragon who resides underneath it, but are likely unaware that the innkeeper is, in fact, the dragon in human form.

NOTES

Unlike many of their kind, silver dragons are very social creatures and spend a great deal of time in the company of humanoids. The dragon residing here opened the inn for that very reason.

If asked, the story the innkeeper will tell is that the inn was built a few years before the dragon moved in. Why the dragon came here is unknown, but it made its home in a cave in the cliffside and appears to be mostly harmless. Occasionally, it has even been helpful, having intervened against bandits and raiders several times.

If asked, the locals will say they have seen the innkeeper and the dragon at the same time. They do not suspect them of being the same person.

If your players are fairly experienced, they may immediately suspect that the innkeeper and the dragon are the same person. If this is the case, you might make an illusionary dragon burst forth from the lair and take to the sky a few minutes after the party finishes talking to the innkeeper. When the party sees the innkeeper behind the bar and the dragon in the sky at the same time, it may reduce their suspicion.

If your players are *very* experienced, I'd recommend a different approach. Make it plainly obvious that the dragon and the innkeeper are the same person. Highly experienced players tend to become skeptical when they feel that the DM *wants* them to believe something and will tend to think that the truth would never be so obvious. Alternatively, the dragon and the innkeeper *could* actually be separate people.

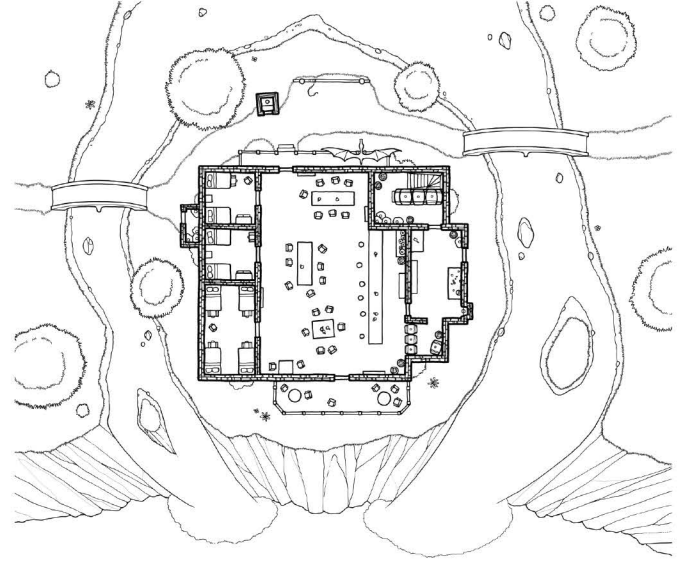

The cliffs beside the inn are 60' (21m) high. The lair entrance behind the waterfall is about 20' (7m) from the top and from the bottom. The tunnel itself is about 20' (7m) high from floor to ceiling.

There is a statue of a silver dragon on the front porch of the inn. This is only a wooden carving covered in grey paint.

The dragon's hoard consists of several piles of gold, a large, silver statue of some ancient hero, and several other things packed away into chests and jars.

While the location of the dragon's lair is commonly known to the locals, they don't dare to go inside it for several reasons. First, because the dragon has helped their community and they respect it. Second, because the cave mouth is somewhat tricky to access. And third, because they're scared of making it angry.

The dragon doesn't rely on the fear of the locals alone to protect its hoard. There are magical traps and sigils throughout the cave that will alert the dragon if anyone enters its lair. Since the dragon is almost always at the inn, it will immediately head downstairs to investigate any intrusion.

